



HAZLETON, PA



KOZ Tax Benefits Through 2017!



Prime Retail Opportunity

Be a part of Hazleton's newest retail destination.



- Located at the intersection of I-81 Exit 143 and Rt. 924 - more than 18,000 cars pass this location daily
- Commercial zoning (B-2) restaurant, retail, hotel services; Flexible pad site planning
- Approved and improved pad sites; Construction-ready
- Traffic signal at Rt. 924 and Commerce Drive (main entrance road)
- Pad-ready sites with public utilities to the parcel line; Off-site storm water retention/detention
- Located in a Keystone Opportunity Zone providing tax incentives to buyers through 2017
- Provides direct access to an industrial park with 7,000 working professionals and more than 50 major tenants
- Eagle Rock Resort featuring 4,000 acres of homes, skiing, golf and other recreation nearby

Owned by:



Presented by:



For more information, e-mail: ACalvanese@lpc.com

Adriano Calvanese
Senior Vice President

One Commerce Square T: 215.564.1715
2005 Market Street, Suite 3135 F: 215.564.1839
Philadelphia, PA 19103 C: 267.939.3232

Neither CAN DO, Lincoln, their affiliates, employees or representatives make any representation or warranty as to the accuracy or reliability of this information. We encourage any user of this information to independently confirm its accuracy and completeness.

HUMBOLDT STATION

HAZLETON, PA



- Available - Big Box Retail
- Available - Retail/Commercial
- Open Area
- Occupied:

- Lot A: Burger King
- Lot B: Turkey Hill Convenience Store
- Lot C: Sonic Restaurant
- Lot I: Residence Inn by Marriott

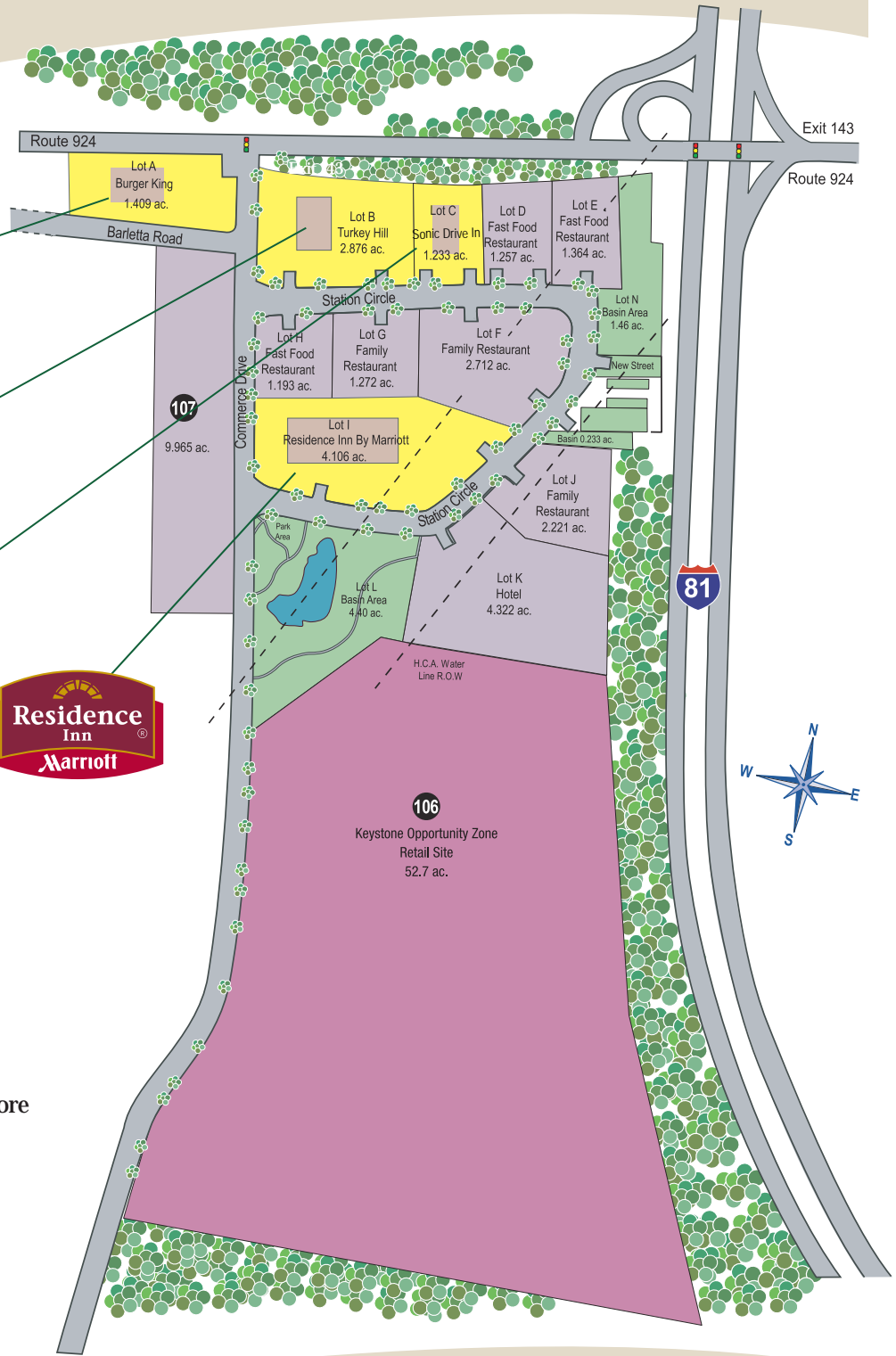

Owned by:



Presented by:



For more information, e-mail: ACalvanese@lpc.com

Adriano Calvanese
Senior Vice President

One Commerce Square
2005 Market Street, Suite 3135
Philadelphia, PA 19103

T: 215.564.1715
F: 215.564.1839
C: 267.939.3232

Neither CAN DO, Lincoln, their affiliates, employees or representatives make any representation or warranty as to the accuracy or reliability of this information. We encourage any user of this information to independently confirm its accuracy and completeness.